

990 SLIDING DOOR



A Smooth Performer Wins Ovations



The Grand America Hotel
Salt Lake City, Utah
ARCHITECT
Smallwood, Reynolds & Associates, Inc., Atlanta, Georgia
GLAZING CONTRACTOR
Steel Encounters, Inc., Salt Lake City, Utah

Kawneer's 990 Sliding Door withstands battering by wind, rain or hail whether the application is high rise or low rise, remodel or new construction. The manual sliding door is a complete package of door, door frame and hardware, thus providing single-source responsibility. Assuring long-term, dependable operation and durability, 990 Sliding Doors have been engineered to meet various levels of performance for residential, commercial and heavy commercial applications.

PERFORMANCE

The 990 Sliding Door meets or exceeds all criteria established by AAMA for ratings of C30, HC40 and HC60. In addition, independently certified test results demonstrate the 990's ability to withstand water infiltration at 10 PSF.

The options offered for the 990 emphasize structural integrity – from standard, mid-range or maximum-range interlocks to lock stile mullions and meeting stiles. The result is a sliding door with exceptional and reliable performance:

- Adjustable tandem roller assemblies with steel ball bearings ensure smooth and trouble-free operation. A stainless steel assembly is optional.
- Positive weather seals on all panel sides limit air infiltration to a minimum.
- The stainless steel track insert resists corrosion and pitting, providing a smooth and durable operating surface.
- The pressure-equalized sill construction provides resistance to water infiltration at 10 PSF.
- Three performance ranges of interlocks, meeting stiles and lock stile mullions provide the flexibility to meet various structural designs.
- The Adams Rite 1848 deadlock (stainless steel optional) or Adams Rite MS 1850-505 hook-bolt lock provide dependable security hardware.

AESTHETICS

The 990 Sliding Door provides a classic design that blends with remodel projects or new construction in a wide range of applications. Screens are optional, and configurations include OX, XO, OXO and OXXO. The minimal stile face width allows virtually uninterrupted vision. There are nine glazing options – from 3/16" to 1" (4.76 mm to 25.4 mm).

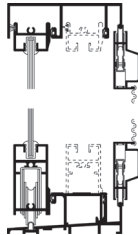

FOR THE FINISHING TOUCH

Permanodic™ anodized finishes are available in Class I and Class II in seven different color choices.

Painted finishes, including fluoropolymer, that meet or exceed AAMA 2605 are offered in many standard choices and an unlimited number of specially designed colors.

Solvent-free powder coatings add the “green” element with high performance, durability and scratch resistance that meet the standards of AAMA 2604.



© Kawneer Company, Inc. 2007–2019
 Form Number 17-2245.A
 Permanodic™ is a trademark of
 Kawneer Company, Inc.

Kawneer Company, Inc.
 Technology Park / Atlanta

555 Guthridge Court
 Norcross, GA 30092

770.449.5555
 kawneer.com



ARCHITECTURAL SYSTEMS | ENTRANCES + FRAMING | CURTAIN WALLS | WINDOWS